

1. Choose our base shape: Paraboloid

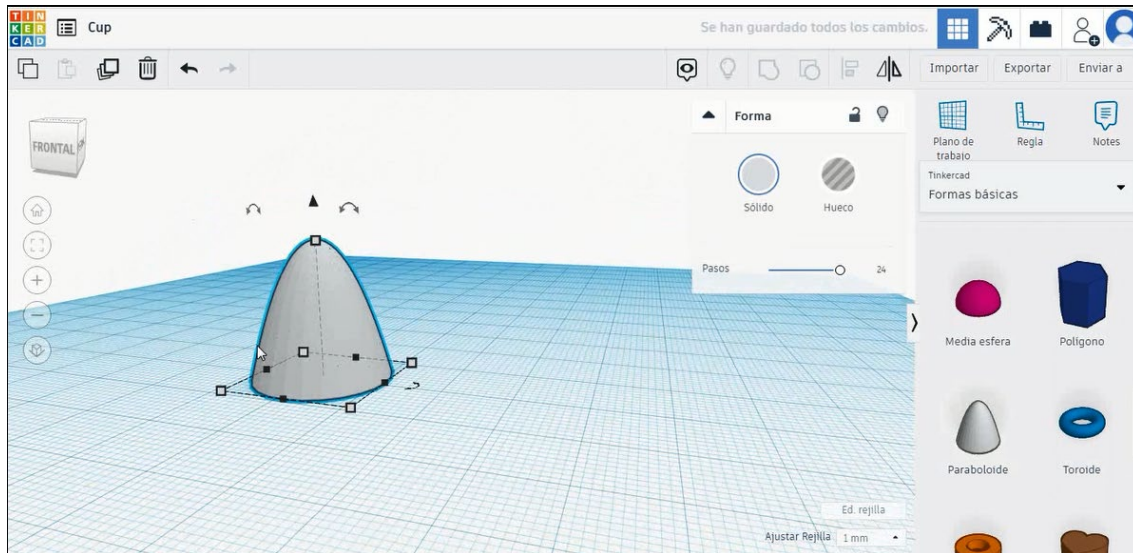

2. Size it to 40x40x50 mm (x,y,z)

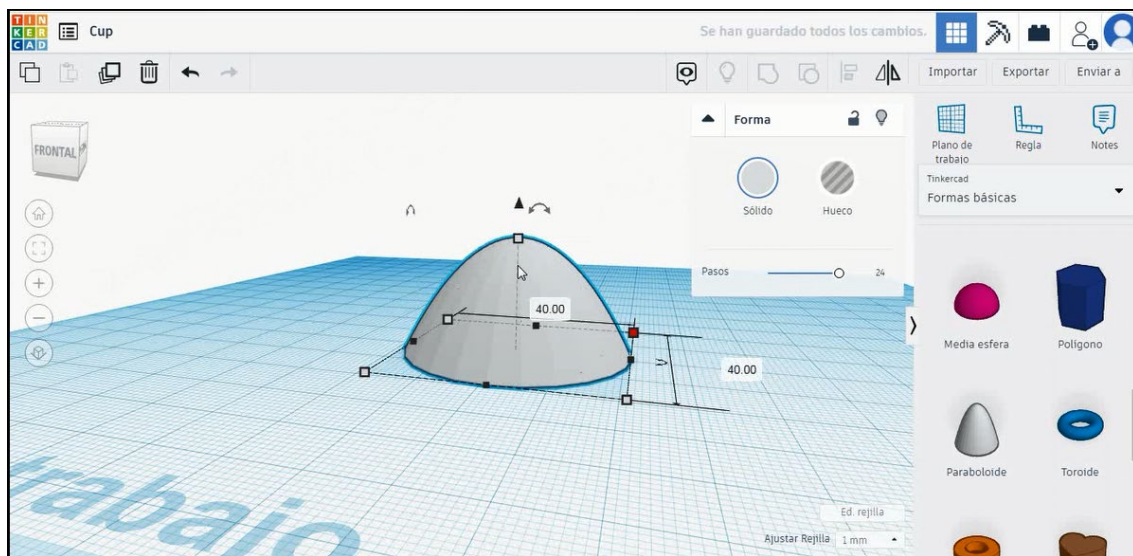

3. In order to create a flat base for the cup, we choose the cube and put it in hole mode

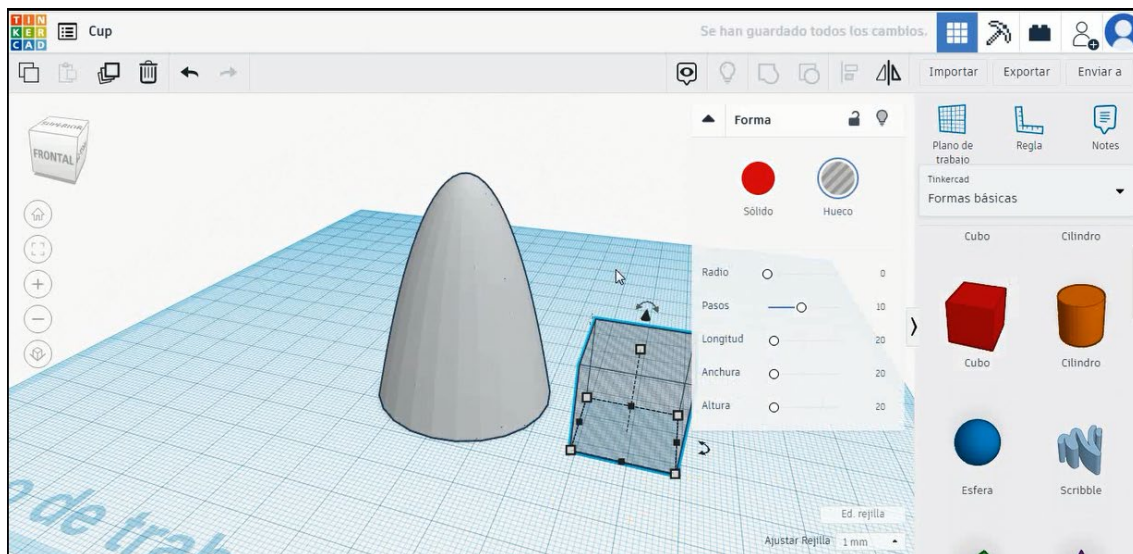

4. Change the measures to make it bigger and place it in the top of the paraboloid.

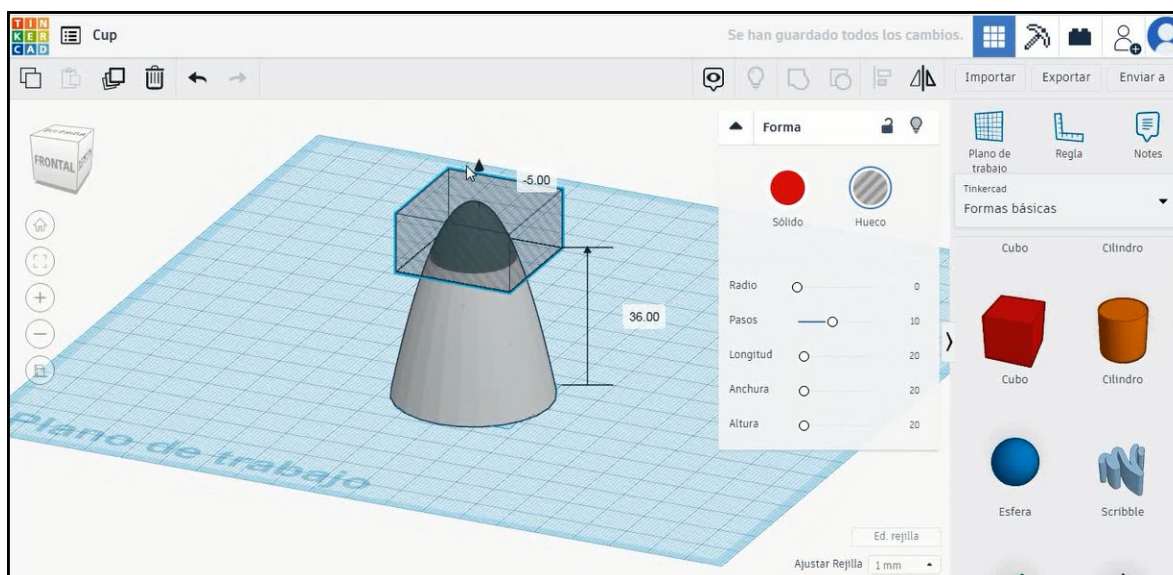

5. Pressing Shift and selecting the paraboloid and the cube , select group

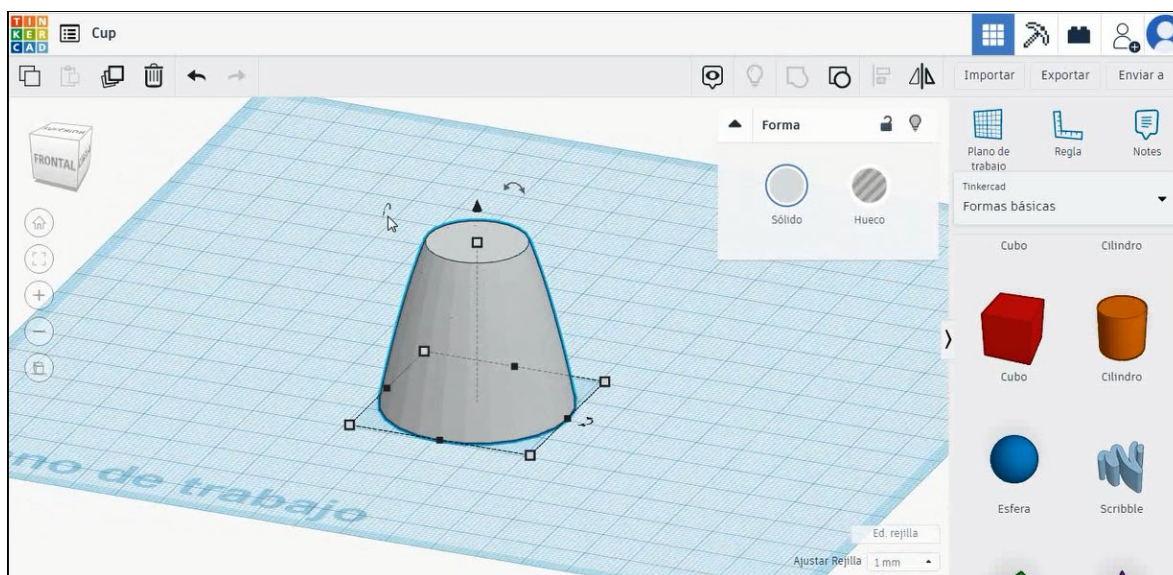
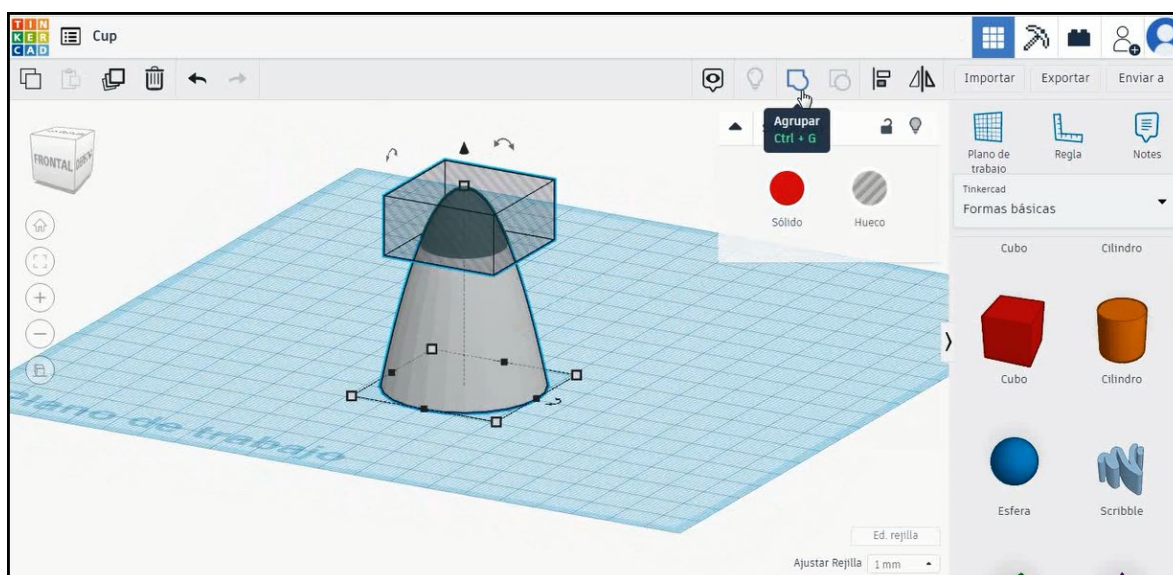

6. Now, we are going to rotate the cup 180 degrees

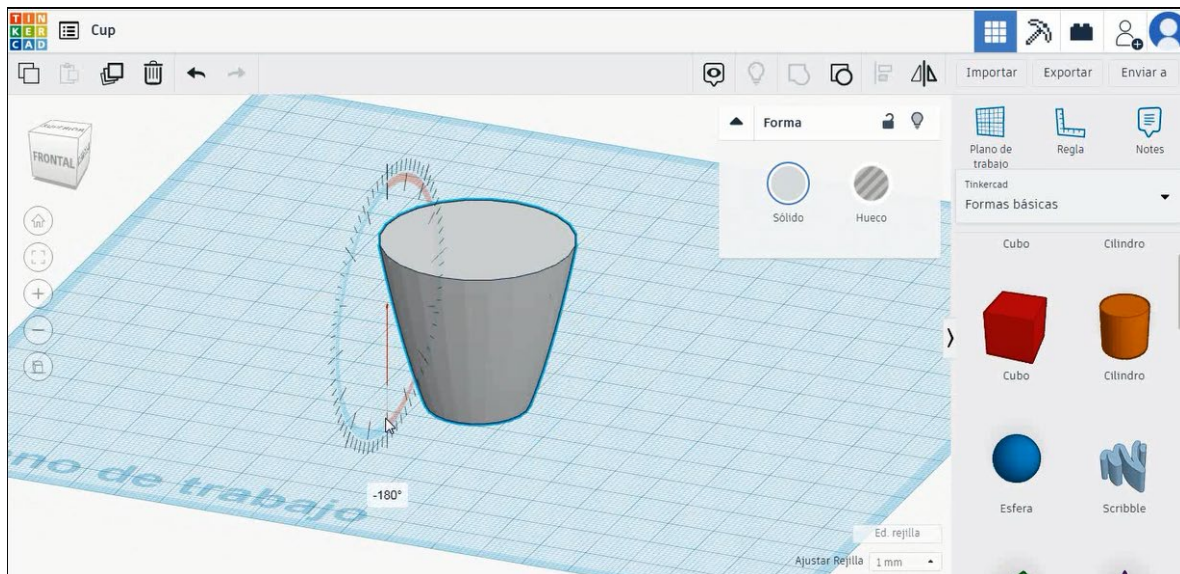

7. Copy the paraboloid shape and size it to 38x38x34 mm, then we put in the center of the original shape. We will use it later to empty the core.

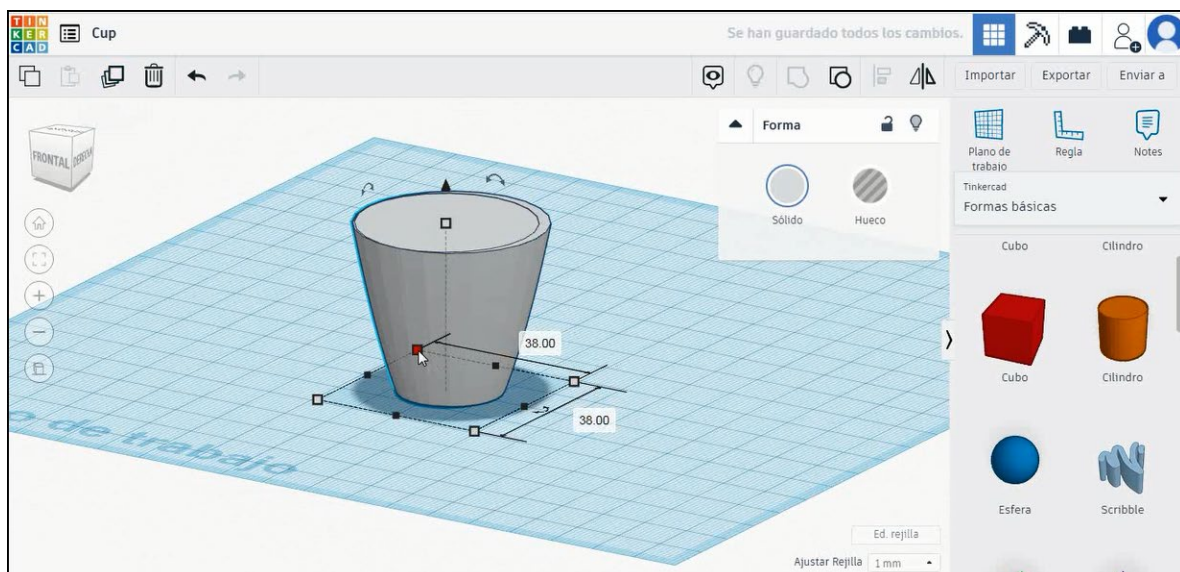
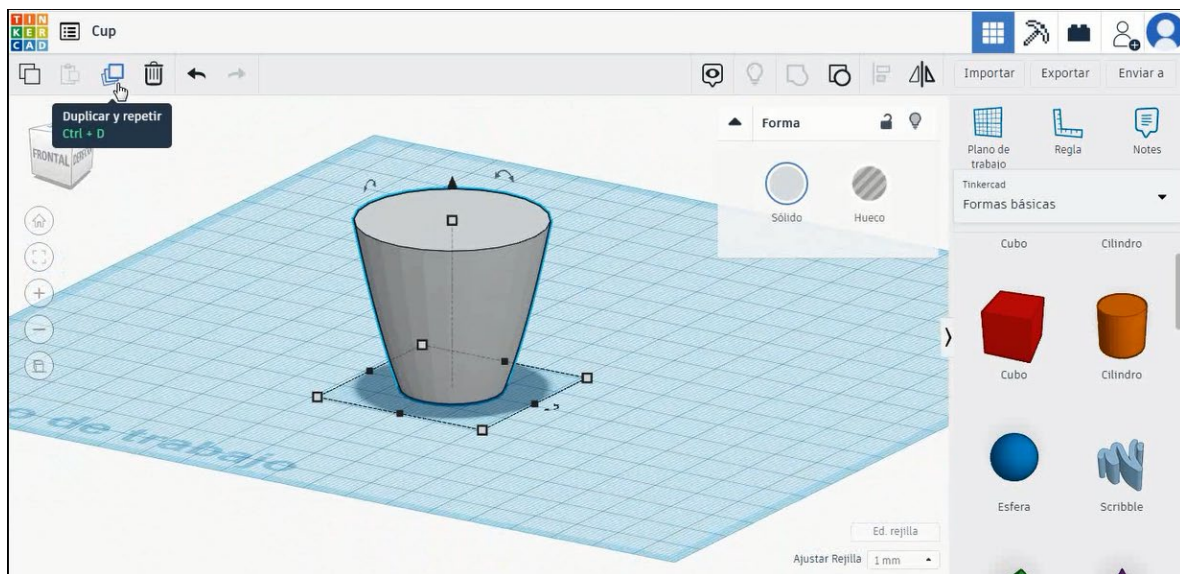

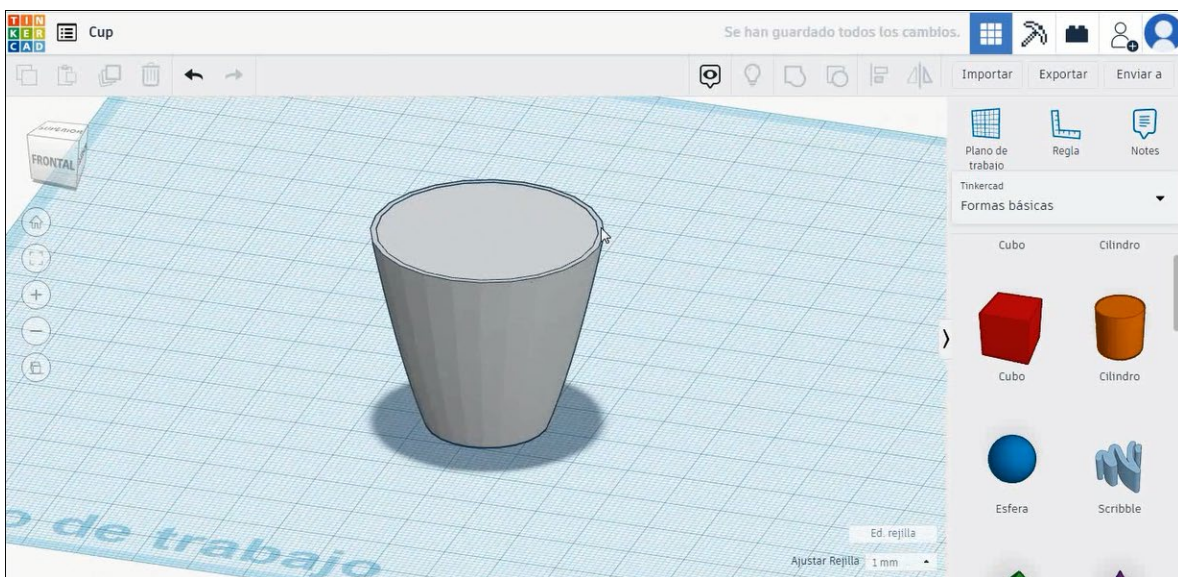
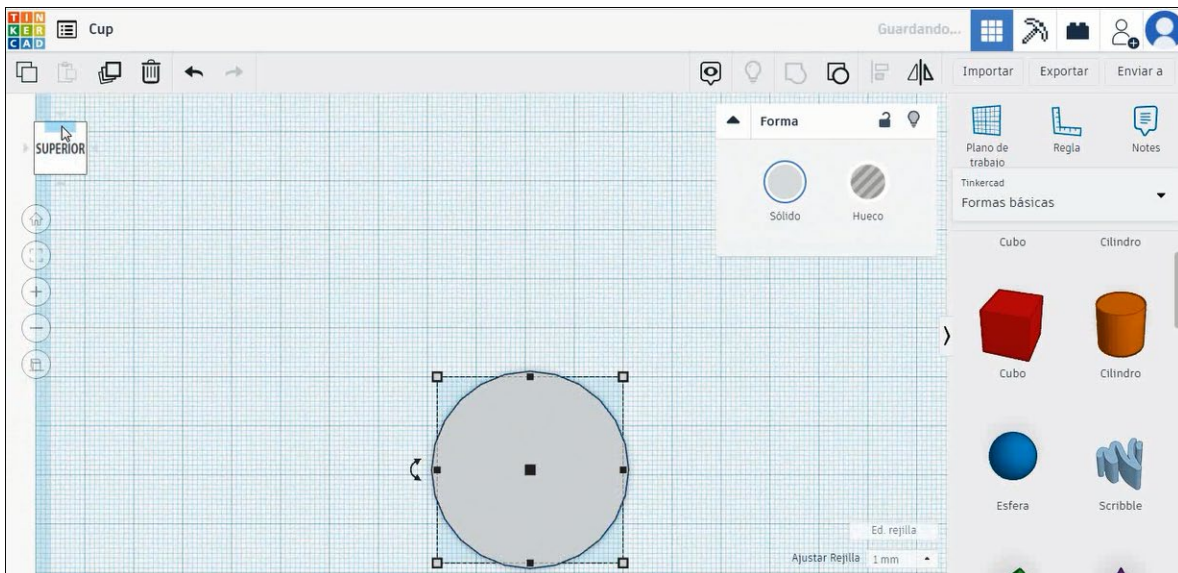

8. To create the handle, choose the torus in color mode and rotate it to put in the right top side of the cup. Then, pressing shif and selecting the cup and the torus press group to merge both.

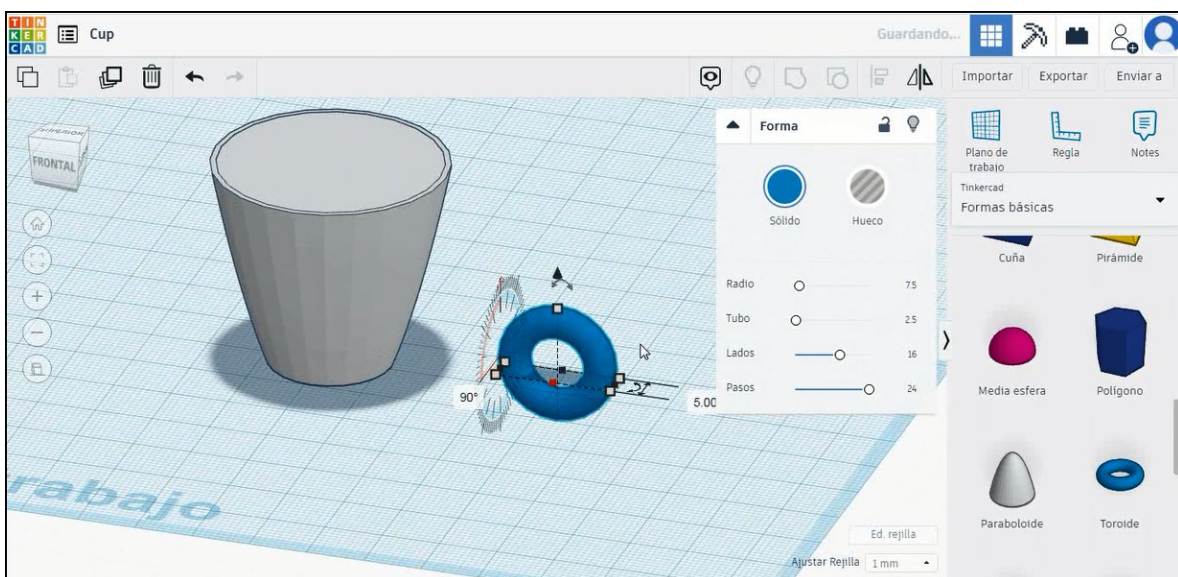

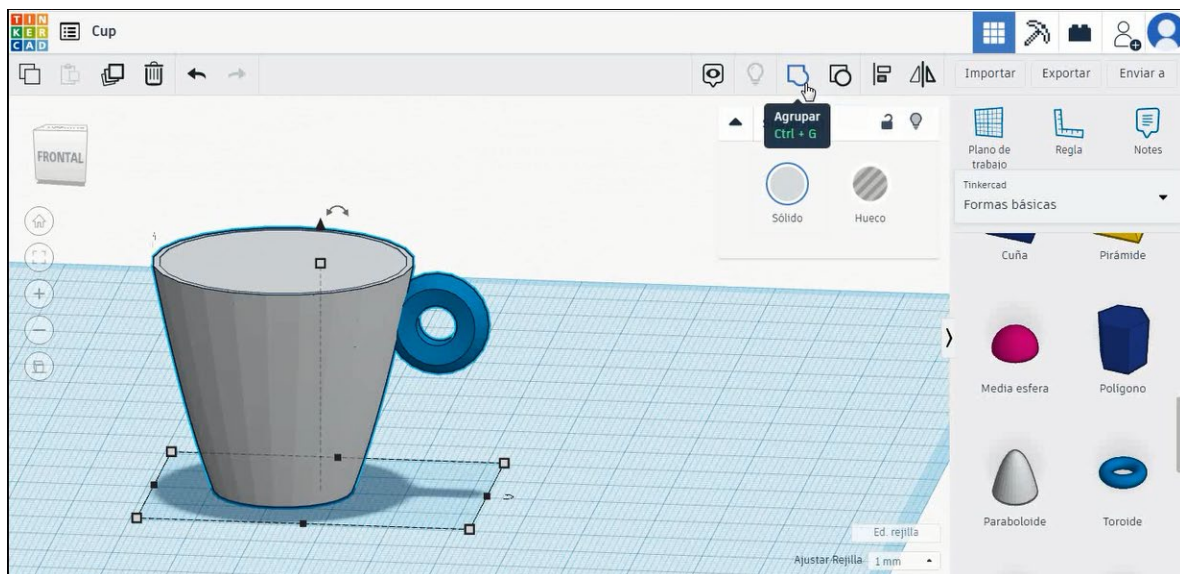
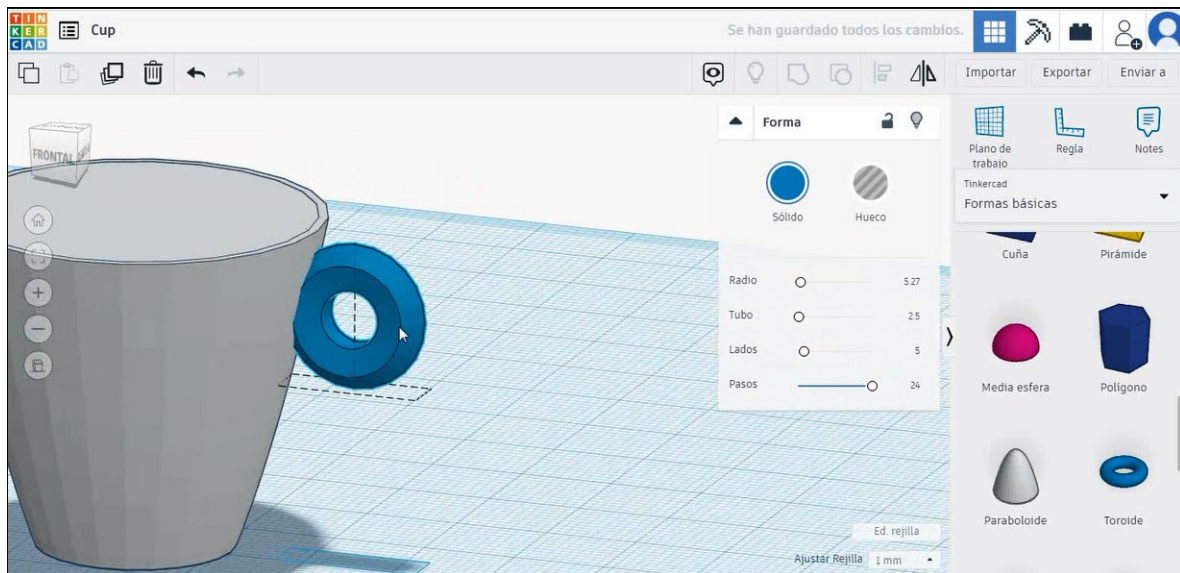

9. Select the smaller paraboloid that we have created before and choose hole mode. Select both entities pressing shift key and then select group to empty the core.

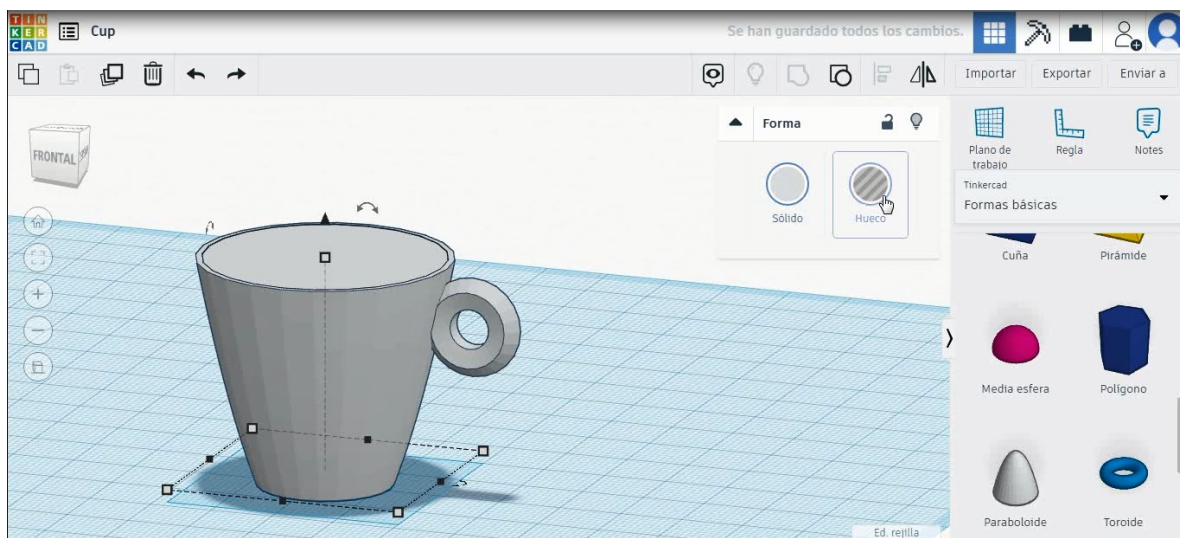

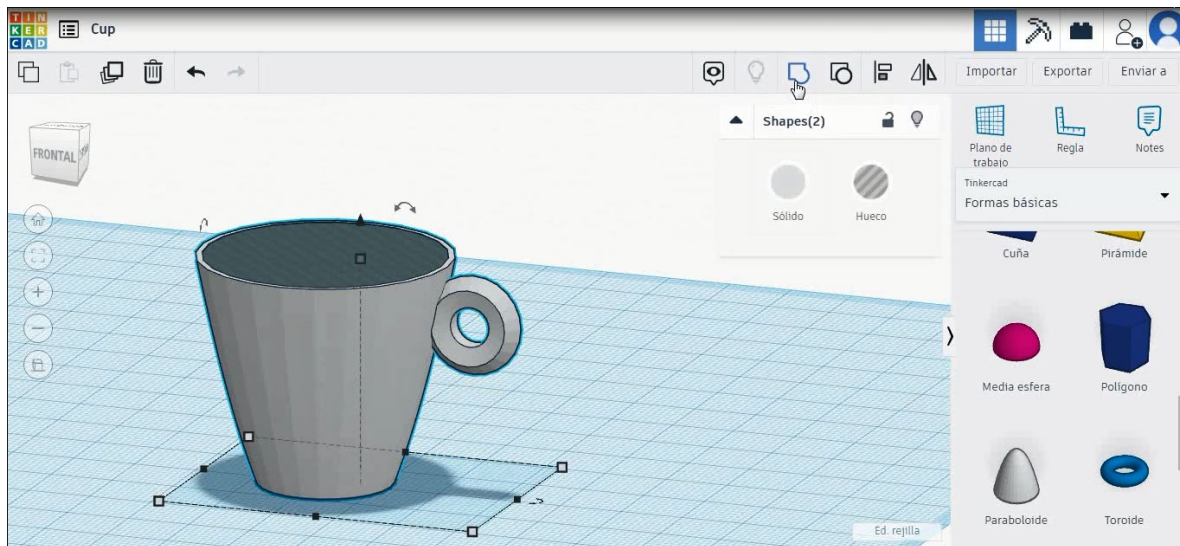

10. Now, the cup is finished.

